

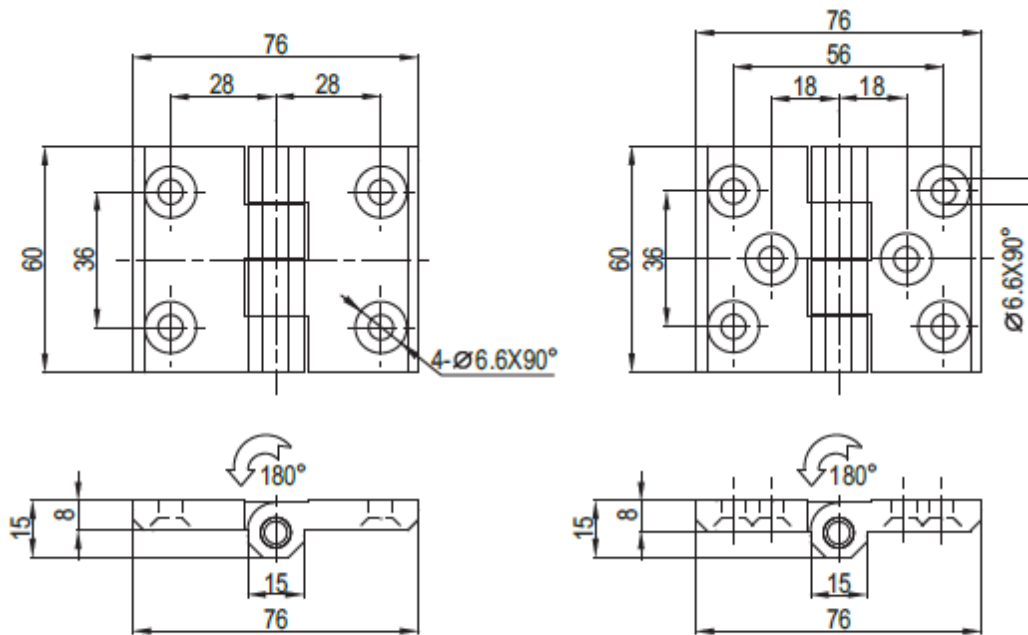

Concept
Latch Lock & Hinge

2101-6764

M6 沉头螺钉固定 Countersunk Screw M6



锌合金，镀锌钢或不锈钢销轴表面处理可做喷塑黑和电镀亮铬，材质可做全不锈钢

Zinc die, m.s. zinc plated or SUS pin, black powder coated or bright chrome, SUS material upon request

螺钉固定铰链 Screw-on Hinge 60X76		
表面处理 Finish	四个 M6 沉头螺丝孔 4 Countersunk Screw hole M6	六个 M6 沉头螺丝孔 6 Countersunk Screw hole M6
喷塑黑 Black Powder Coated	2101-6764-10	2101-6766-10
亮铬 Bright Chrome	2101-6764-30	2101-6766-30