

CONFIDENTIAL NOTICE: This drawing and the designs, specifications and engineering information disclosed hereon are the property of Eberhard Manufacturing Company and are not to be disseminated or reproduced without express written consent. The drawing is loaned in confidence and then only for consideration of the matter disclosed hereon. In accepting loan of this drawing, recipient agrees to keep it and the matter disclosed hereon in confidence and not to use nor permit their use in any way detrimental to Eberhard Manufacturing Company, Division of the Eastern Company. 21944 Drake Road, Cleveland, Ohio 44149-9712 © 2012 EBERHARD MFG. CO.

NOTES:

- 1) MATERIAL: SAE J429, GRADE 8.
- 2) FINISH: ZINC WITH YELLOW CONVERTER (EBERHARD'S FC 64)
OR ZINC W/BLACK CHROMATE (EBERHARD'S FC 73)
- 3) INSTALLATION: TORQUE TO 45/50 ft./lbs.
- 5) FOR BOXED QUANTITIES OF 250 PCS, ORDER P/N: 2T-400-52BX250.

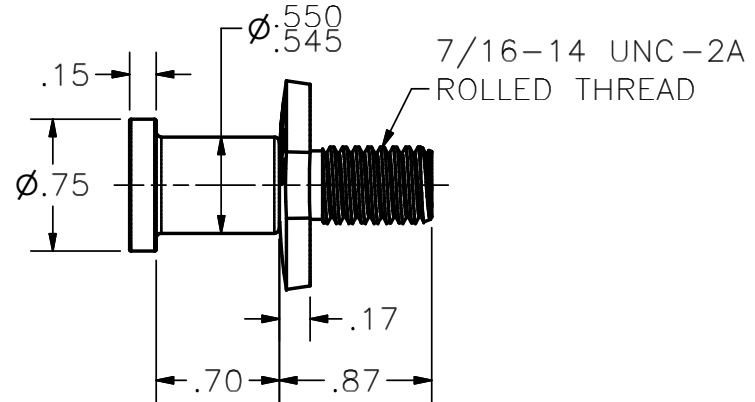
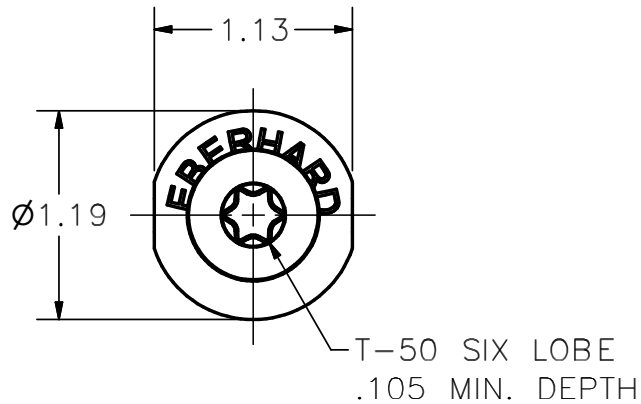

SUPERSEDES DRAWING 2T-400-52 SHEET 1 OF 2 DATED 6-16-2009.

CUSTOMER PRINT
SHEET 1 OF 2

LINEAR MEASURE: INCH UNLESS OTHERWISE SPECIFIED TOLERANCES ARE AS FOLLOWS: IN MM ANGLES: $\pm 2'$ $\pm 2'$ 2 PLACE DEC.: $\pm .03$ $\pm .76$ 3 PLACE DEC.: $\pm .015$ $\pm .38$ ALL HOLES: $\pm .005$ $\pm .13$		DATE 7/19/2012 DR. BY SAA SCALE FULL CHK. BY	EBERHARD MANUFACTURING CO. DIVISION OF THE EASTERN COMPANY CLEVELAND, OHIO 44149-9712	NAME SIX LOBE STRIKER PIN ASSEMBLY
REVISIONS: REV DESCRIPTION EN DATE		THIS DOCUMENT IS IN ACCORDANCE WITH ASME Y14.15-2009	MATERIAL SEE NOTE	PART NUMBER 2T-400-52

C:\Working_Folder\Archive\FASSTENER\STRIKERS\2T-400-52 SH1 .idw