

CONFIDENTIAL NOTICE: This drawing and the designs, specifications and engineering information disclosed herein are the property of Eberhard Manufacturing Company and are not to be disseminated or reproduced without express written consent. The drawing is loaned in confidence and then only for consideration of the matter disclosed herein. In accepting loan of this drawing, recipient agrees to keep it and the matter disclosed herein in confidence and not to use nor permit their use in any way detrimental to Eberhard Manufacturing Company, Division of the Eastern Company, 21944 Drake Road, Cleveland, Ohio 44149-9712. © 2013 EBERHARD MFG. CO.

REVISION HISTORY			
REV	DESCRIPTION	EN	DATE
1	REVISED, REDRAWN AND CONVERTED TO 3D	5592	2-22-13

PART No.	SURFACE APPEARANCE	AVAILABLE FINISHES	A	B	C
501-634-K	TEXTURED	(05)(30)	.13	.80	2.43
501-635-K	TEXTURED	(05)(30)	.75	1.25	2.86
501-636-K	TEXTURED	(05)(30)	1.25	1.75	3.43
501-637-K	TEXTURED	(05)(30)	1.75	2.25	3.89
501-634S-K	SMOOTH	(42)(03)(CS)	.13	.80	2.43
501-635S-K	SMOOTH	(42)(03)(CS)	.75	1.25	2.86
501-636S-K	SMOOTH	(42)(03)(CS)	1.25	1.75	3.43
501-637S-K	SMOOTH	(42)(03)(CS)	1.75	2.25	3.89

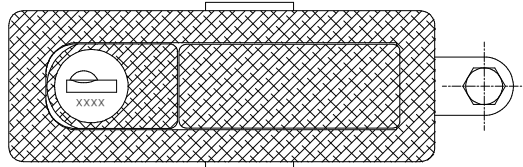

TEXTURED TOP VIEW

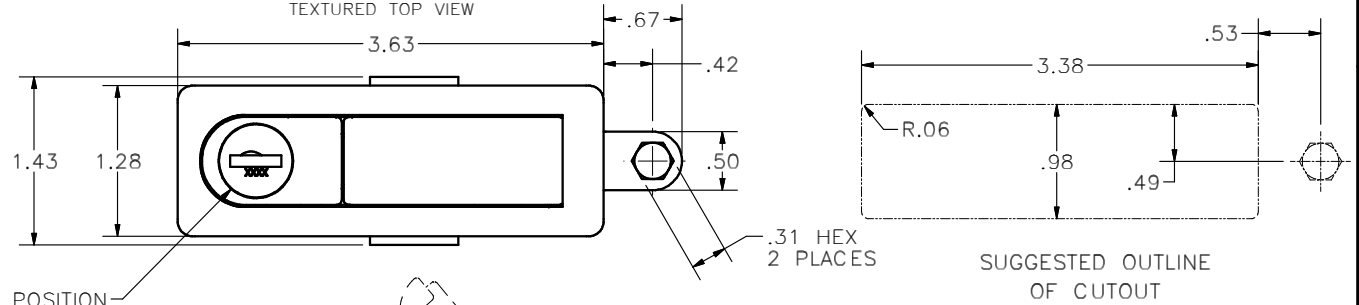

PANEL RANGE
.031 MIN./ .312 MAX

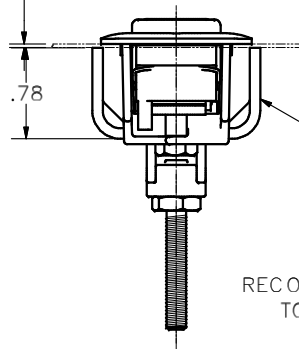

MOUNTING BRACKET

"SEMS" STYLE
HEX HEAD SCREW
RECOMMENDED TIGHTENING
TORQUE: 10-15 in-lbs

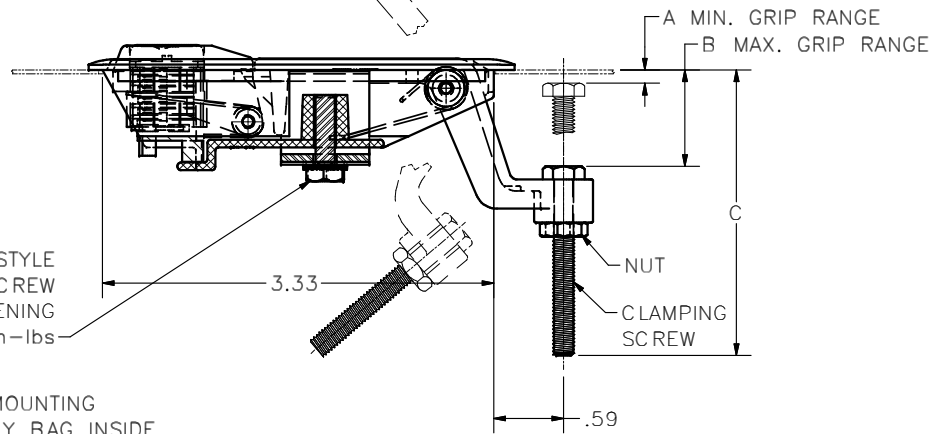

- NOTES:
- "SEMS" STYLE SCREW, CLAMPING SCREW, NUT, AND MOUNTING BRACKET TO BE SHIPPED LOOSE IN A SECURED POLY BAG INSIDE LARGER POLY BAG TO PREVENT SCRATCHING.
 - FINISH DESCRIPTION:
 - A. UNPLOISHED CHROME, FC (05)
 - B. BLACK POWDER COAT, FC (30)
 - C. TEXTURED BLACK POWDER, FC (42)
 - D. BRIGHT CHROME, FC (03)
 - E. CAMARO SILVER, FC (CS)
 - KEY NO'S 501-510, 545 & 751 TO BE ORDERED AS PART OF THE AVAILABLE PART NUMBER AS SHOWN.

SUPERSEDES DRAWING 634-K CHART SHEET 1 OF 2 DATED 6-11-05

CUSTOMER PRINT
SHEET 1 OF 2

EBERHARD MANUFACTURING CO. DIVISION OF THE EASTERN COMPANY CLEVELAND, OHIO 44149-9712	
NAME KEY LOCKING ADJUSTABLE TRIGGER LATCH W/ BRACKET	PART NUMBER CHART 634-K
MATERIAL	*

THIS DOCUMENT IS IN ACCORDANCE WITH ASME Y14.15-2009	
LINEAR MEASURE: INCH UNLESS OTHERWISE SPECIFIED TOLERANCES ARE AS FOLLOWS:	DATE 2/22/2013
IN MM ANGLES: ± 2° ± 2° 2 PLACE DEC.: ± .03 ± .76 3 PLACE DEC.: ± .015 ± .38 ALL HOLES: ± .005 ± .13	DR. BY FLP SCALE FULL CHK. BY