

Clevis pins

Material: Low carbon steel, plain finish

Custom options on request. MOQ's may apply.



Clevis Pins may also be called Hitch Pins, Cold Headed Pins, Headed Pins or Cold Formed Pins.

Standard Clevis Pins are cold headed per IFI standards except for hole and point dimensions. All Clevis Pin holes are chamfered for a superior part finish! Only the finest cold heading quality wire is used. Some Cotter Pins that we have available for use with Clevis Pins include Bow-Tie Locking Cotters, Rue-Ring Locking Cotters, Circle Cotters and Hair Pin Cotters.

Special Clevis Pin configurations and grades are available, with various material options including medium carbon steel and alloy steel. Heat treated clevis pins are available per your requirements, including Grade 5 and Grade 8 Clevis Pins. Different head styles are available including button heads, truss heads and pan heads.

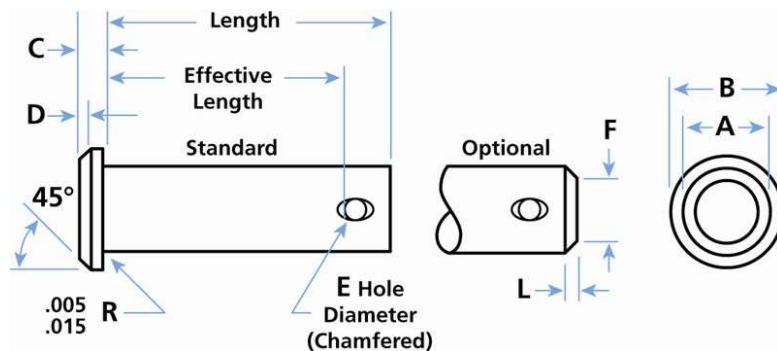

Part Number	Basic Shank Diameter [in]	Length [in]	Length under Head: To Edge of Hole (Approx.) [in]	Material
CP-2	3/16	1/2	0.359	Plain finish steel
CP-4	3/16	19/32	0.453	Plain finish steel
CP-6	3/16	5/8	0.484	Plain finish steel
CP-8	3/16	3/4	0.609	Plain finish steel
CP-10	3/16	7/8	0.734	Plain finish steel
CP-12	3/16	1	0.859	Plain finish steel
CP-14	3/16	1 1/4	1.109	Plain finish steel
CP-16	3/16	1 1/2	1.359	Plain finish steel



Part Number	Basic Shank Diameter [in]	Length [in]	Length under Head: To Edge of Hole (Approx.) [in]	Material
CP-20	3/16	2	1.859	Plain finish steel
CP-22	3/16	2 1/2	2.359	Plain finish steel
CP-24	3/16	3	2.859	Plain finish steel
CP-26	1/4	1/2	0.359	Plain finish steel
CP-28	1/4	5/8	0.484	Plain finish steel
CP-30	1/4	3/4	0.609	Plain finish steel
CP-32	1/4	51/64	0.656	Plain finish steel
CP-34	1/4	7/8	0.734	Plain finish steel
CP-36	1/4	1	0.859	Plain finish steel
CP-38	1/4	1 1/8	0.984	Plain finish steel
CP-40	1/4	1 1/4	1.109	Plain finish steel
CP-42	1/4	1 3/8	1.234	Plain finish steel
CP-44	1/4	1 1/2	1.359	Plain finish steel
CP-46	1/4	1 5/8	1.484	Plain finish steel
CP-48	1/4	1 3/4	1.609	Plain finish steel
CP-50	1/4	1 7/8	1.734	Plain finish steel
CP-52	1/4	2	1.859	Plain finish steel
CP-54	1/4	2 1/8	1.984	Plain finish steel
CP-56	1/4	2 1/4	2.109	Plain finish steel
CP-62	1/4	2 1/2	2.359	Plain finish steel
CP-66	1/4	2 3/4	2.609	Plain finish steel
CP-68	1/4	3	2.859	Plain finish steel
CP-70	1/4	3 1/2	3.359	Plain finish steel
CP-72	1/4	4	3.859	Plain finish steel
CP-76	5/16	1/2	0.313	Plain finish steel
CP-78	5/16	3/4	0.563	Plain finish steel
CP-80	5/16	7/8	0.688	Plain finish steel
CP-82	5/16	31/32	0.781	Plain finish steel
CP-84	5/16	1	0.813	Plain finish steel
CP-86	5/16	1 1/8	0.938	Plain finish steel
CP-88	5/16	1 3/16	1	Plain finish steel
CP-90	5/16	1 1/4	1.063	Plain finish steel
CP-92	5/16	1 3/8	1.188	Plain finish steel
CP-94	5/16	1 1/2	1.313	Plain finish steel
CP-100	5/16	1 3/4	1.563	Plain finish steel
CP-104	5/16	1 7/8	1.688	Plain finish steel
CP-108	5/16	2	1.813	Plain finish steel
CP-110	5/16	2 1/8	1.938	Plain finish steel
CP-114	5/16	2 1/4	2.063	Plain finish steel
CP-116	5/16	2 3/8	2.188	Plain finish steel
CP-118	5/16	2 1/2	2.313	Plain finish steel



Part Number	Basic Shank Diameter [in]	Length [in]	Length under Head: To Edge of Hole (Approx.) [in]	Material
CP-122	5/16	2 3/4	2.563	Plain finish steel
CP-128	5/16	3	2.813	Plain finish steel
CP-134	5/16	3 1/2	3.313	Plain finish steel
CP-136	5/16	4	3.813	Plain finish steel
CP-140	3/8	3/4	0.516	Plain finish steel
CP-142	3/8	1	0.766	Plain finish steel
CP-144	3/8	1 3/32	0.859	Plain finish steel
CP-146	3/8	1 1/8	0.891	Plain finish steel
CP-148	3/8	1 1/4	1.016	Plain finish steel
CP-150	3/8	1 5/16	1.078	Plain finish steel
CP-152	3/8	1 3/8	1.141	Plain finish steel
CP-154	3/8	1 1/2	1.266	Plain finish steel
CP-156	3/8	1 5/8	1.391	Plain finish steel
CP-158	3/8	1 3/4	1.516	Plain finish steel
CP-160	3/8	1 7/8	1.64	Plain finish steel
CP-162	3/8	2	1.766	Plain finish steel
CP-164	3/8	2 1/8	1.891	Plain finish steel
CP-166	3/8	2 1/4	2.016	Plain finish steel
CP-168	3/8	2 3/8	2.141	Plain finish steel
CP-170	3/8	2 1/2	2.266	Plain finish steel
CP-172	3/8	2 5/8	2.391	Plain finish steel
CP-174	3/8	2 3/4	2.516	Plain finish steel
CP-176	3/8	3	2.766	Plain finish steel
CP-178	3/8	3 1/4	3.016	Plain finish steel
CP-180	3/8	3 1/2	3.266	Plain finish steel
CP-182	3/8	3 3/4	3.516	Plain finish steel
CP-184	3/8	4	3.766	Plain finish steel
CP-188	7/16	1	0.766	Plain finish steel
CP-190	7/16	1 15/64	1	Plain finish steel
CP-192	7/16	1 1/4	1.016	Plain finish steel
CP-194	7/16	1 1/2	1.266	Plain finish steel
CP-198	7/16	1 3/4	1.516	Plain finish steel
CP-200	7/16	2	1.766	Plain finish steel
CP-202	7/16	2 1/4	2.016	Plain finish steel
CP-206	7/16	2 1/2	2.266	Plain finish steel
CP-212	7/16	3	2.766	Plain finish steel
CP-214	7/16	3 1/2	3.266	Plain finish steel
CP-216	7/16	4	3.766	Plain finish steel
CP-218	1/2	1	0.766	Plain finish steel
CP-220	1/2	1 1/4	1.016	Plain finish steel
CP-222	1/2	1 27/64	1.188	Plain finish steel



Concept Latch Lock & Hinge

Part Number	Basic Shank Diameter [in]	Length [in]	Length under Head: To Edge of Hole (Approx.) [in]	Material
CP-226	1/2	1 3/4	1.516	Plain finish steel
CP-228	1/2	2	1.766	Plain finish steel
CP-230	1/2	2 1/4	2.016	Plain finish steel
CP-232	1/2	2 1/2	2.266	Plain finish steel
CP-234	1/2	2 5/8	2.391	Plain finish steel
CP-236	1/2	2 3/4	2.516	Plain finish steel
CP-238	1/2	3	2.766	Plain finish steel
CP-240	1/2	3 1/2	3.266	Plain finish steel
CP-242	1/2	4	3.766	Plain finish steel
CP-244	1/2	4 1/2	4.266	Plain finish steel
CP-246	1/2	5	4.766	Plain finish steel
CP-258	5/8	1 1/4	1.016	Plain finish steel
CP-260	5/8	1 1/2	1.266	Plain finish steel
CP-262	5/8	1 3/4	1.516	Plain finish steel
CP-264	5/8	2	1.766	Plain finish steel
CP-266	5/8	2 1/4	2.016	Plain finish steel
CP-268	5/8	2 1/2	2.266	Plain finish steel
CP-270	5/8	3	2.766	Plain finish steel
CP-272	5/8	3 1/2	3.266	Plain finish steel
CP-274	5/8	4	3.766	Plain finish steel