

CONFIDENTIAL NOTICE: This drawing and the designs, specifications and engineering information disclosed herein are the property of Eberhard Manufacturing Company and are not to be disseminated or reproduced without express written consent. The drawing is loaned in confidence and then only for consideration of the matter disclosed herein. In accepting loan of this drawing, recipient agrees to keep it and the matter disclosed herein in confidence and not to use nor permit their use in any way detrimental to Eberhard Manufacturing Company, Division of the Eastern Company, 21944 Drake Road, Cleveland, Ohio 44149-9712 © 2014 EBERHARD MFG. CO.

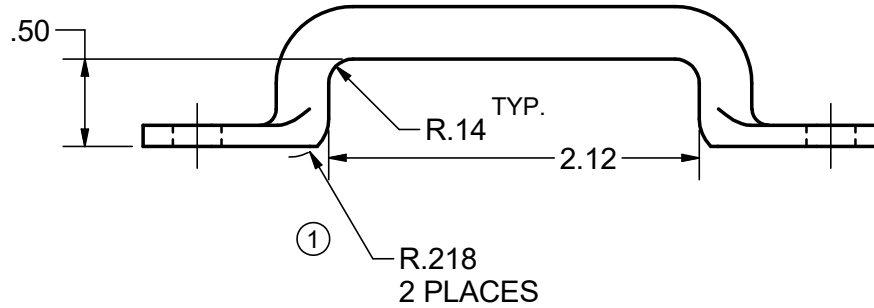
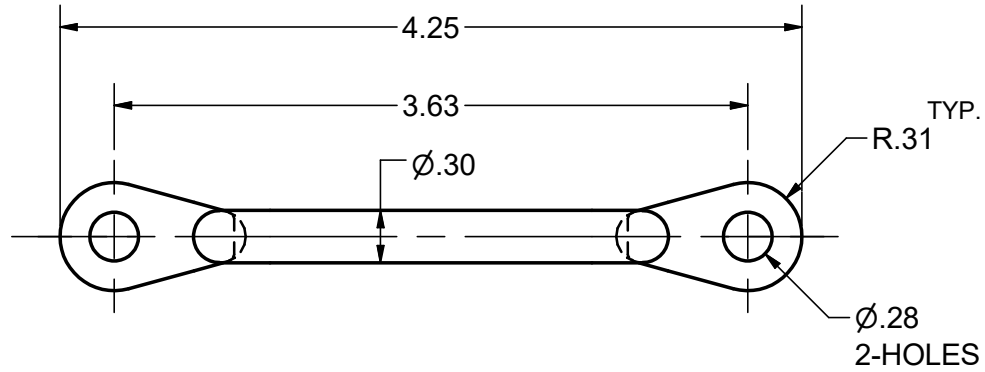

NOTE: FINISHES:
 A. PLAIN, FC (01)
 B. NICKEL, FC (11)
 C. E-COAT, FC (23)
 D. ELECTROPLATED ZINC, FC (25)
 E. ZINC W/BLACK CHROMATE, FC (73)

②

CUSTOMER LEVEL
 SHEET 1 OF 2

SUPERSEDES DRAWING 6411-H SHEET 1 OF 2 DATED 7-28-03.

LINEAR MEASURE: INCH UNLESS OTHERWISE SPECIFIED TOLERANCES ARE AS FOLLOWS:				DATE 12/7/2012	EBERHARD MANUFACTURING CO. DIVISION OF THE EASTERN COMPANY CLEVELAND, OHIO 44149-9712	NAME FOOTMAN LOOP	
ANGLES: ± 2° ± 2°				DR. BY FLP		MATERIAL .30 DIA. STEEL 1006/1015	PART NUMBER 6411-H
2 PLACE DEC.: ± .03 ± .76				SCALE FULL			
3 PLACE DEC.: ± .015 ± .38				CHK. BY	THIS DOCUMENT IS IN ACCORDANCE WITH ASME Y14.15-2009		
ALL HOLES: ± .005 ± .13							

2	REMOVED: FC (GR)	5677	10-24-14
1	ADDED RADII R.218	5584	12-21-12
	CONVERTED TO 3D	5582	12-7-12
REV	DESCRIPTION	EN	DATE

C:\TEMP\l89b813a-95ee-4a26-b697-bd68a8e4f0bd\FASTENER\FEETMAN LOOPS\6411-H SH1.idw