

LEVER LATCH



LL-66



• Latch designed to be used on a door without knobs or handles.

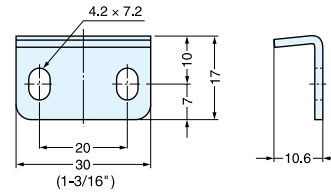
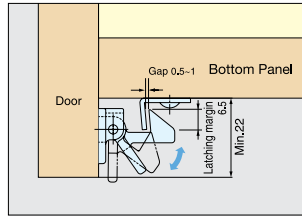
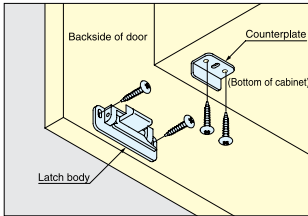
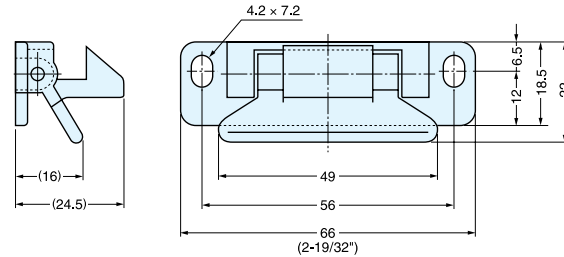

Item No.	Holding Force (kg)	Weight (g)	Box (pcs)	Carton (pcs)
LL-66/BRN	20 (44 lbs)	25	30	300
LL-66/WHT				
LL-66/GR*				
LL-66/BLK				

Part Name	Material	Color
Latch Body	Polyamide	White (WHT)
Lever		Brown (BRN)
		Grey (GR)
Counterplate	Steel	Nickel

*LL-66/GR: UL-94 V0 rated flame retardant material.

STAINLESS STEEL LEVER LATCH



LL-66S



• Latch designed to be used on a door without knobs or handles.
• 316 Stainless steel construction makes it ideal for harsh and high corrosive environments.

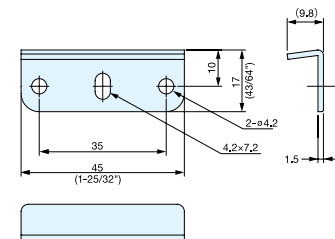
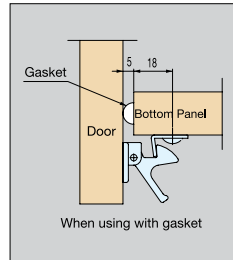
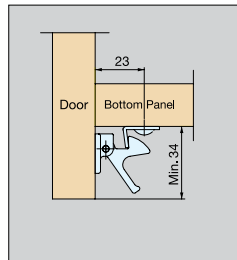
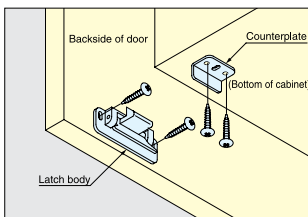
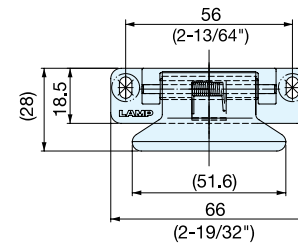
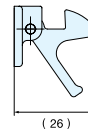

Item No.	Holding Force (kg)	Weight (g)	Box (pcs)	Carton (pcs)
LL-66S	20 (44 lbs)	85	20	100

Part Name	Material	Color
Latch Body	SCS14 Stainless Steel (Similar to SUS316)	Mirror
Lever		Plain
Counterplate	316 Stainless Steel	Mirror
Spring		Plain