

## Model 01 CH - Clamping Handle Male

Below you will find the standard version of this product which is suitable for most applications. However all our products can easily be produced in different moulding materials (including ABS, polypropylene or different levels of glass filled nylon), with different insert materials (such as stainless steel, brass, alloy or various zinc plating) and with non-standard thread lengths and/or sizes. The MOQ for most modifications is only 300 pieces so please feel free to contact our Sales Team, who will be happy to advise and quote for exactly the product you need.

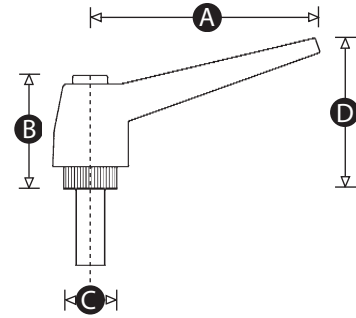
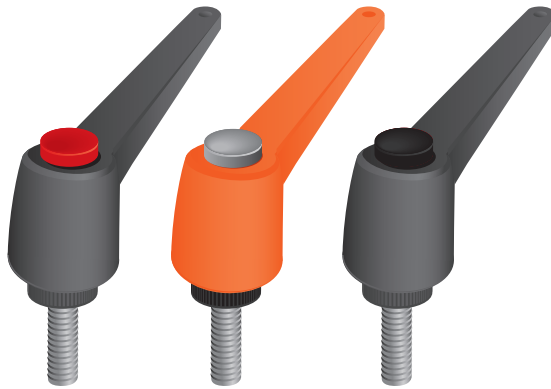

PATTERN	PART NO. Black/ Red	PART NO. Orange/ Grey	PART NO. Black/ Black	A	B	C	D	THREAD SIZE	THREAD LENGTH	WEIGHT (g)	Material:	High impact resistant thermoplastic - matt finish Brass
2843/M	11433V	11460X	11554V	43	26	12	32	M5	15	8.8	Insert material:	Brass
2843/M	11434R	11461T	11555R	43	26	12	32	M5	20	9.2	Standard Colour:	Black handle + red cap / Orange handle + grey cap / Black handle + black cap
2843/M	11435Y	11462P	11556Y	43	26	12	32	M5	25	9.8	Colour Options:	A wide range of RAL colours can be produced - MOQs apply
2843/M	11436U	11463W	11557U	43	26	12	32	M6	15	8.7		
2843/M	11437Q	11464S	13068P	43	26	12	32	M6	20	9.3		
2843/M	11438X	11465Z	11559X	43	26	12	32	M6	25	9.5	Note:	This product consists of 2 parts: the handle and a cap - different colour combinations are possible - there is no added charge for different coloured caps
2865/M	11439T	11466V	13069W	65	37	15	46	M8	20	25.5		
2865/M	11440P	11467R	11561P	65	37	15	46	M8	30	26.9		
2865/M	11441W	11468Y	13070S	65	37	15	46	M8	40	28.3		
2865/M	11442S	11469U	11563S	65	37	15	46	M8	50	34.6		
2883/M	11443Z	11470Q	11564Z	83	46	19	57	M10	30	43.2		
2883/M	11444V	11471X	13071Z	83	46	19	57	M10	40	51.6		
2883/M	11445R	11472T	11566R	83	46	19	57	M10	50	55.7		
28104/M	11446Y	11473P	11567Y	104	51	24	68	M12	30	69.8		
28104/M	11447U	11474W	11568U	104	51	24	68	M12	35	78.0		
28104/M	11448Q	11475S	11569Q	104	51	24	68	M12	50	80.0		
28104/M	11449X	11476Z	11570X	104	51	24	68	M16	35	82.0		
28104/M	11450T	11477V	11571T	104	51	24	68	M16	50	85.0		

All dimensions are in mm (unless otherwise stated) and are approximate. All weights are in grams and are approximate.



**RencolComponents Ltd.**

Unit 2, Avonbridge Estate - Atlantic Road - Avonmouth - Bristol BS11 9QD - UK - Tel: +44 117 916 0090 - Fax +44 117 982 2235

[www.rencol.com](http://www.rencol.com)