

SS HD

**Handle material**

Die cast zinc

**Insert material**

Blackened steel or stainless steel boss and ratchet with allen key fixing screw.

**Male thread**

Steel or stainless steel.

**Handle colours**

Black handle as standard. Other RAL colours on request (MOQs apply).

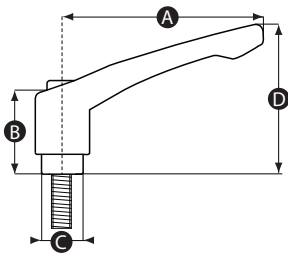

| Part No. | A  | B  | C  | D  | Thread size | Thread length (mm) | Insert material |
|----------|----|----|----|----|-------------|--------------------|-----------------|
| 12075Q   | 42 | 25 | 10 | 37 | M5          | 16                 | Blackened steel |
| 12076X   | 42 | 25 | 10 | 37 | M5          | 20                 | Blackened steel |
| 12090W   | 42 | 25 | 10 | 37 | M5          | 20                 | Stainless steel |
| 12091S   | 42 | 25 | 10 | 37 | M5          | 25                 | Stainless steel |
| 12082V   | 42 | 25 | 10 | 37 | M6          | 16                 | Blackened steel |
| 12083R   | 42 | 25 | 10 | 37 | M6          | 20                 | Blackened steel |
| 12085U   | 42 | 25 | 10 | 37 | M6          | 32                 | Blackened steel |
| 12096U   | 42 | 25 | 10 | 37 | M6          | 16                 | Stainless steel |
| 12097Q   | 42 | 25 | 10 | 37 | M6          | 20                 | Stainless steel |
| 12099T   | 42 | 25 | 10 | 37 | M6          | 32                 | Stainless steel |
| 12104V   | 65 | 31 | 14 | 49 | M6          | 25                 | Blackened steel |
| 12105R   | 65 | 31 | 14 | 49 | M6          | 32                 | Blackened steel |
| 12118U   | 65 | 31 | 14 | 49 | M6          | 32                 | Stainless steel |
| 12119Q   | 65 | 31 | 14 | 49 | M6          | 40                 | Stainless steel |

Continued overleaf »

« Continued from overleaf

| Part No. | A  | B  | C  | D  | Thread size | Thread length (mm) | Insert material |
|----------|----|----|----|----|-------------|--------------------|-----------------|
| 12108Q   | 65 | 31 | 14 | 49 | M8          | 16                 | Blackened steel |
| 12109X   | 65 | 31 | 14 | 49 | M8          | 20                 | Blackened steel |
| 12110T   | 65 | 31 | 14 | 49 | M8          | 25                 | Blackened steel |
| 12111P   | 65 | 31 | 14 | 49 | M8          | 32                 | Blackened steel |
| 12112W   | 65 | 31 | 14 | 49 | M8          | 40                 | Blackened steel |
| 12113S   | 65 | 31 | 14 | 49 | M8          | 50                 | Blackened steel |
| 12122P   | 65 | 31 | 14 | 49 | M8          | 20                 | Stainless steel |
| 12123W   | 65 | 31 | 14 | 49 | M8          | 25                 | Stainless steel |
| 12124S   | 65 | 31 | 14 | 49 | M8          | 32                 | Stainless steel |
| 12125Z   | 65 | 31 | 14 | 49 | M8          | 40                 | Stainless steel |
| 12126V   | 65 | 31 | 14 | 49 | M8          | 50                 | Stainless steel |
| 12128Y   | 78 | 36 | 16 | 57 | M10         | 20                 | Blackened steel |
| 12130Q   | 78 | 36 | 16 | 57 | M10         | 32                 | Blackened steel |
| 12131X   | 78 | 36 | 16 | 57 | M10         | 40                 | Blackened steel |
| 12132T   | 78 | 36 | 16 | 57 | M10         | 50                 | Blackened steel |
| 12135S   | 78 | 36 | 16 | 57 | M10         | 20                 | Stainless steel |
| 12137V   | 78 | 36 | 16 | 57 | M10         | 32                 | Stainless steel |
| 12138R   | 78 | 36 | 16 | 57 | M10         | 40                 | Stainless steel |
| 12142X   | 92 | 43 | 19 | 65 | M10         | 20                 | Blackened steel |
| 12144P   | 92 | 43 | 19 | 65 | M10         | 32                 | Blackened steel |
| 12145W   | 92 | 43 | 19 | 65 | M10         | 40                 | Blackened steel |
| 12146S   | 92 | 43 | 19 | 65 | M10         | 50                 | Blackened steel |
| 12160R   | 92 | 43 | 19 | 65 | M10         | 50                 | Stainless steel |
| 12161Y   | 92 | 43 | 19 | 65 | M10         | 63                 | Stainless steel |
| 12151U   | 92 | 43 | 19 | 65 | M12         | 32                 | Blackened steel |
| 12152Q   | 92 | 43 | 19 | 65 | M12         | 40                 | Blackened steel |
| 12153X   | 92 | 43 | 19 | 65 | M12         | 50                 | Blackened steel |
| 12154T   | 92 | 43 | 19 | 65 | M12         | 63                 | Blackened steel |
| 12165T   | 92 | 43 | 19 | 65 | M12         | 32                 | Stainless steel |
| 12166P   | 92 | 43 | 19 | 65 | M12         | 40                 | Stainless steel |

Continued on facing page »

« Continued from facing page

| Part No. | A   | B  | C  | D  | Thread size | Thread length (mm) | Insert material |
|----------|-----|----|----|----|-------------|--------------------|-----------------|
| 12167W   | 92  | 43 | 19 | 65 | M12         | 50                 | Stainless steel |
| 12168S   | 92  | 43 | 19 | 65 | M12         | 63                 | Stainless steel |
| 12171R   | 108 | 51 | 23 | 77 | M16         | 40                 | Blackened steel |
| 12176T   | 108 | 51 | 23 | 77 | M16         | 40                 | Stainless steel |