

**Material**

High impact resistant thermoplastic

**Standard colour**

Black

**Finish**

Matt

**Female insert material**

Brass

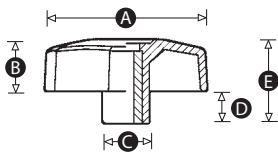

Part No.	A	B	C	D	E	Thread size
8990Z	28	11	12.5	6	17	M5
5094S	28	11	12.5	6	17	M6
8986T	40	12	17	8	20	M6
8402X	40	12	17	8	20	M8
4844T	50	15	18	9	24	M6
7452R	50	15	18	9	24	M8
11533R	60	18	20	12	30	M8
8959R	60	18	20	12	30	M10