

**Material**

Duroplast

**Standard colour**

Black

**Finish**

Gloss

**Male thread material**

Zinc plated steel

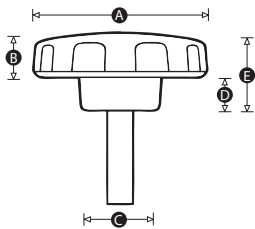

Part No.	A	B	C	D	E	Thread size	Thread length (mm)
4070V	32	11	12	8	19	M6	15
1306X	32	11	18	8	19	M6	20
1307T	32	11	18	8	19	M6	25
1308P	32	11	12	8	19	M6	30
1325Y	44	13	24	8	21	M8	20
1327Q	44	13	24	8	21	M8	25
2861P	44	13	24	8	21	M8	30
2868T	57	18	18	12	27	M10	20
1343S	57	15	25	12	27	M10	30
4683P	57	15	25	12	27	M10	40
1361X	70	18	28	14	32	M12	40
5405P	70	18	28	14	32	M12	50