

**Material**

High impact resistant thermoplastic

**Standard colour**

Black

**Finish**

Matt

**Female insert material**

Brass or zinc plated steel

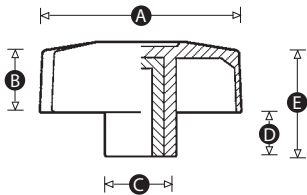

| Part No. | A  | B  | C  | D  | E  | Thread size | Insert material   |
|----------|----|----|----|----|----|-------------|-------------------|
| 8974X    | 28 | 11 | 11 | 6  | 17 | M5          | Brass             |
| 5106P    | 28 | 11 | 11 | 6  | 17 | M6          | Brass             |
| 8975T    | 40 | 12 | 15 | 8  | 20 | M6          | Brass             |
| 15172S   | 40 | 12 | 15 | 8  | 20 | M6          | Zinc plated steel |
| 9505W    | 40 | 12 | 15 | 8  | 20 | M8          | Brass             |
| 15173Z   | 40 | 12 | 15 | 8  | 20 | M8          | Zinc plated steel |
| 11532V   | 50 | 15 | 15 | 9  | 24 | M6          | Brass             |
| 8967S    | 50 | 15 | 15 | 9  | 24 | M8          | Brass             |
| 4834T    | 60 | 18 | 20 | 12 | 30 | M8          | Brass             |
| 8963X    | 60 | 18 | 20 | 12 | 30 | M10         | Brass             |
| 15180T   | 60 | 18 | 20 | 12 | 30 | M8          | Zinc plated steel |