

**Material**

Duroplast

**Standard colour**

Black

**Finish**

Gloss finish

**Bore**

Push-fit assembly with tolerance ring

**Shaft diameter**

Imperial and metric sizes

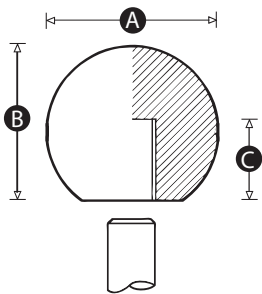

Part No.	A	B	C	Shaft type	To fit shaft diameter - H9 tolerance (mm)	To fit shaft diameter - H9 tolerance (inches)
1469U	19	17	12	Plain	-	0.188
1471X	19	17	12	Plain	-	0.25
1474W	25	23	15	Plain	-	0.25
1478R	25	23	15	Plain	-	0.313
1476P	32	30	17	Plain	-	0.25
1482X	32	30	15	Plain	-	0.313
1484P	32	30	20	Plain	-	0.375
1490Y	38	36	20	Plain	-	0.375
1491U	38	36	20	Plain	-	0.5
1493X	44	43	20	Plain	-	0.5
1511R	44	43	23	Plain	-	0.625
1494T	51	49	20	Plain	-	0.5
1512Y	51	49	23	Plain	-	0.625

Continued overleaf »

« Continued from overleaf

Part No.	A	B	C	Shaft type	To fit shaft diameter - H9 tolerance (mm)	To fit shaft diameter - H9 tolerance (inches)
1496W	19	17	13	Plain	5	-
1498P	19	17	13	Plain	6	-
1500R	25	23	16	Plain	6	-
1503Q	25	23	15	Plain	8	-
1502U	32	30	16	Plain	6	-
1505T	32	30	15	Plain	8	-
1528P	32	30	19	Plain	10	-
1531P	38	36	19	Plain	10	-
1536Q	38	36	20	Plain	12	-
1542P	44	43	20	Plain	12	-
1549T	44	43	23	Plain	16	-
3025P	51	49	20	Plain	12	-
1551W	51	49	23	Plain	16	-