

**Material**

High impact resistant thermoplastic

**Standard colour**

Black

**Finish**

Matt finish

**Bore**

Push-fit assembly

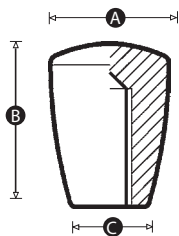

Part No.	A	B	C	To fit shaft diameter - H9 tolerance (mm)
8748Z	15	20	10	5
8530R	18	25	12	6
8531Y	24	33	16	8
8532U	24	33	16	10
8745P	28	38	18	10
8455U	31	43	21	10
8456Q	31	43	21	12