



Quick Release Pull Pin

Material: Zinc plated steel



Our “Standard” Quick-Release Pull Pins are also known as spring plungers, hand retractable spring plungers or stubby spring plungers – due to their shorter body when compared to a Quarter-Turn Locking Spring Pin.

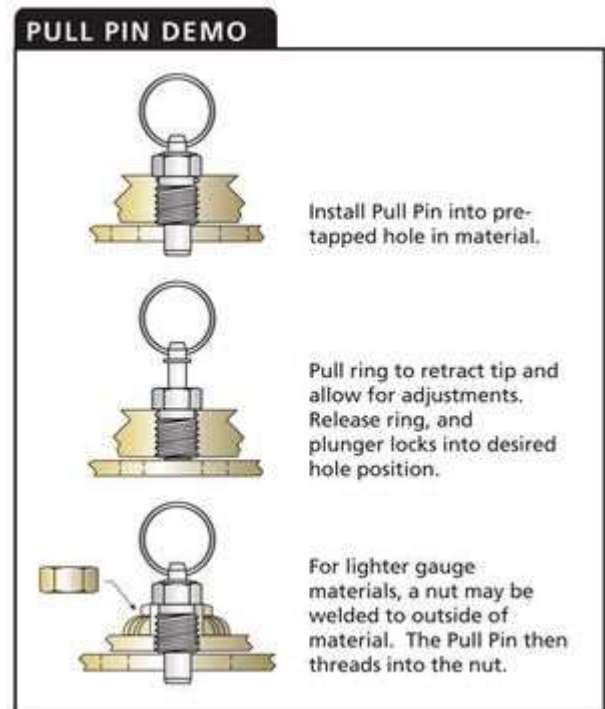

The Quick-Release Pull Pin body is threaded into the application, with ring on outside surface. Pull the ring to retract spring-loaded tip and allow adjustments. Release the ring to lock Pull Pin tip into desired hole location. Chamfered tip allows for easy alignment. Spring Plungers are ideal for adjustable tubing, tooling, latches, fixtures, gates, and much more. Steel Lanyards or Nylon Lanyards may be added to the Spring Plunger ring as a low cost “pull actuator”.

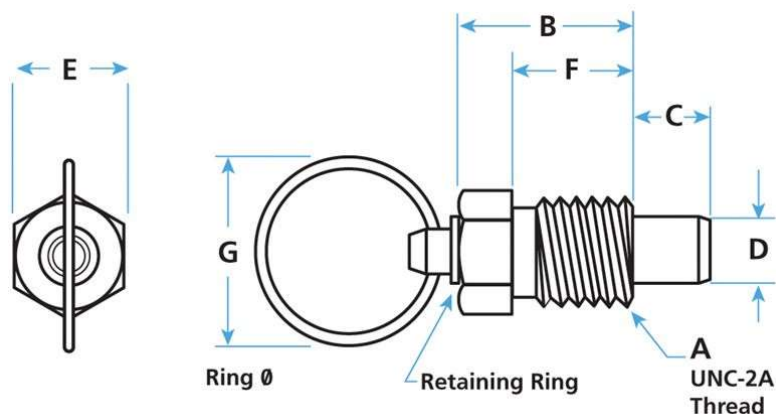

Part Number	Thread - A [in]	D [in]	B [in]	C [in]	F [in]	Material
PULL-250X	1/4 - 20	0.160	0.440	0.190	0.310	Zinc Plated Steel
PULL-375X	3/8-16	0.250	0.630	0.280	0.440	Zinc Plated Steel
PULL-500X	1/2-13	0.310	0.810	0.380	0.560	Zinc Plated Steel
PULL-625X	5/8-11	0.380	1.000	0.440	0.690	Zinc Plated Steel