

## Diecast Hinge 2101-961-20

- Zinc diecast, black powder coated
- 180 degree opening angle
- Size 90 x 60mm, 8mm thick
- 6 x M8 threaded studs
- Left handed P/N 2101-961-20L
- Right handed P/N 2101-961-20R
- Chrome Left handed P/N 2101-961-79L
- Chrome Right handed P/N 2101-961-79R

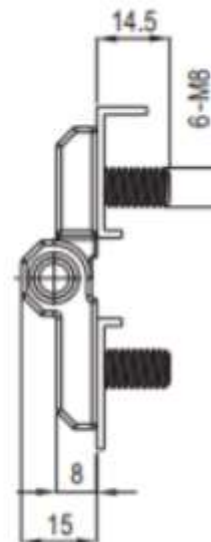
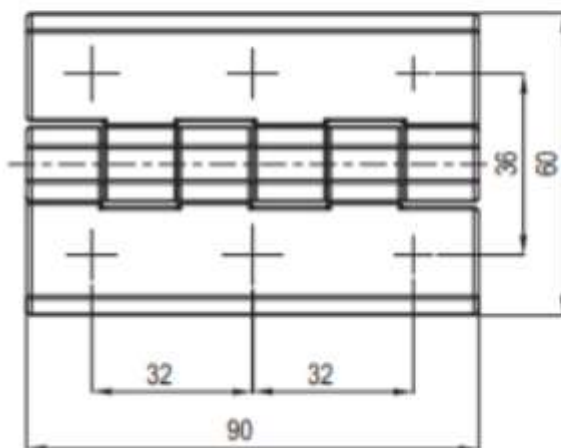

All measurements are in mm