

Spring Plungers · smooth EH 22070.



Product Description

Especially designed for the use in tool-making.
Usable as ejection pins and spring stops.
It is impossible for the complete spring plunger or any of its individual parts to come out of the retaining bore.

Material

- Pin**
- Steel, case-hardened, blackened
 - Stainless Steel 1.4305, nitrided

Body

- Free cutting steel, blackened
- Stainless steel 1.4305

Spring

- stainless steel

More information

Notes

Special types on request.
Spring plungers are specially tested for spring range and forces.

Drawing

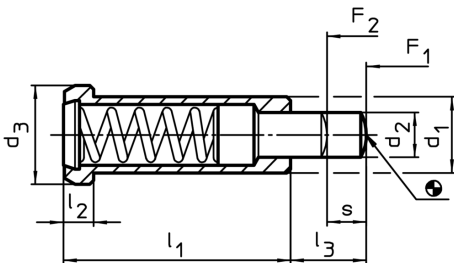

Order information

d ₁ -0.05	Dimensions					Stroke s [mm]	Spring load ¹⁾		max. [°C]	Location hole H7 [mm]	[g]	Art. No.
	d ₂	d ₃	l ₁	l ₂	l ₃		F ₁ ~ [N]	F ₂ ~ [N]				
free cutting steel, standard spring load												
6	2.7	8	20	3.2	6	3.5	10	22	250	6	4.0	22070.0006
8	3.9	10	24	3.2	8	4.5	30	88	250	8	7.5	22070.0008
10	5.9	13	30	4.0	10	5.5	42	110	250	10	15.0	22070.0010
12	7.9	16	36	5.0	12	6.5	50	130	250	12	27.0	22070.0012
stainless steel, standard spring load												
6	2.7	8	20	3.2	6	3.5	10	22	250	6	4.0	22070.0106
8	3.9	10	24	3.2	8	4.5	30	88	250	8	7.5	22070.0108
10	5.9	13	30	4.0	10	5.5	42	110	250	10	15.0	22070.0110
12	7.9	16	36	5.0	12	6.5	50	130	250	12	27.0	22070.0112

¹⁾ statistical average value

Application example

