

## RAISED COUNTER BRACKET CTB Series



- Allow for additional floating countertops, expanding your counter space.  
Comes in two mounting options: top-mounted and wall-mounted.
- Designed to allow cables to be put through. (Max. diameter:  $\phi 10.5$ )

### [Applications]

- Commercial reception counters, kitchens, serving bars, and more.

### [Remarks]

- Please make sure the support structure that the bracket will be attached to is strong enough to handle the load.
- The length can be customized to your projects. Please contact us for more information.

### [Colour Finishes]



### [Wiring Cables]

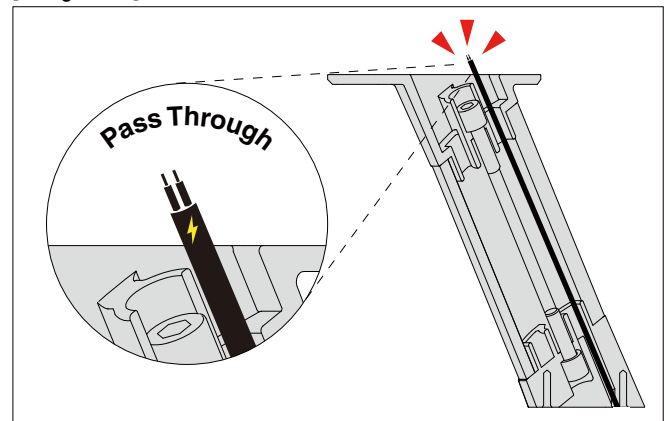

Can be used with LED lights and electric appliances.

## Series Lineup

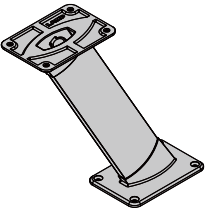
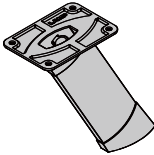
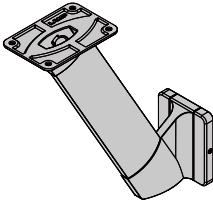
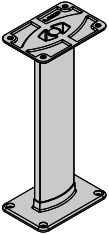
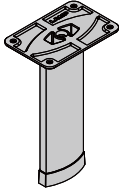
|        |     | Mounting Options  |   |  |
|--------|-----|---|---|--|
|        |     | Top-Mounted   |   | Wall-Mounted   |
|        |     | Front-Screw   | Back-Screw  | Front-Screw  |
| Angles | 60° | <br>CTB65-PMS60-240 <b>1</b> | <br>CTB65-PM60-170 <b>2</b><br>CTB50-PM60-170 (Slim-type) <b>6</b> | <br>CTB65-VM60-300 <b>5</b> |
|        | 90° | <br>CTB65-PMS90-270 <b>3</b> | <br>CTB65-PM90-200 <b>4</b>  |  |

Refer to **1** **2**: PC2, **3** **4**: PC3, **5** **6**: PC4

Three finishes are available in each model.

**RAISED COUNTER BRACKET CTB65-PMS60-240 60° / Top-mounted / Front-screw**

- Allows for additional floating countertops, expanding your counter space.
- Designed to allow cables to be put through. (Max. diameter:  $\phi$  10.5)

**[Applications]**

- Commercial reception counters, kitchens, serving bars, and more.

**[Remarks]**

- Please make sure the support structure that the bracket will be attached to is strong enough to handle the load.
- Max. pitch of adjoining brackets is 900 mm.
- Max. size of countertop overhung is 1,000 mm in width and 400 mm in depth. (when using two brackets)
- Min. thickness of a countertop overhung is 20 mm.  
Min. thickness of a countertop that will support an additional countertop is 30 mm.

**[Remarks]**

- Countersunk tapping screw M5×20

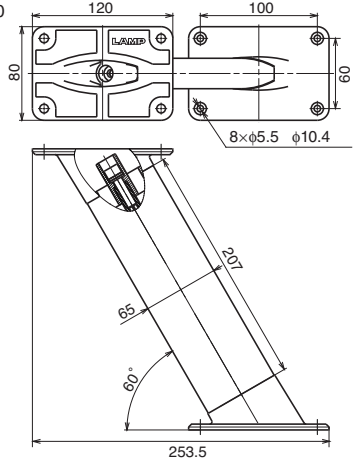
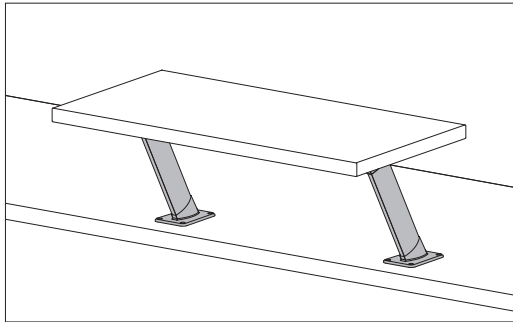
**[Installation]**

| RoHS | CAD  | Item Code   | Item Name          | Angle | Mount       | Screw | Colour Finish   | Material        | Load Capacity N / pc | Load Capacity kgf / pc | Weight (g) | Box  | Carton |
|------|------|-------------|--------------------|-------|-------------|-------|-----------------|-----------------|----------------------|------------------------|------------|------|--------|
| CE   | 2030 | 120-041-442 | CTB65-PMS60-240-SL | 60°   | Top-mounted | Front | Stainless Steel | Aluminium Alloy | 600                  | 61.2                   | 570        | 1 pc | 10 pcs |
| CE   | 2030 | 120-041-443 | CTB65-PMS60-240-BL |       |             |       | Black           |                 |                      |                        |            | 1 pc | 10 pcs |
| CE   | 2030 | 120-041-444 | CTB65-PMS60-240-WT |       |             |       | White           |                 |                      |                        |            | 1 pc | 10 pcs |

**RAISED COUNTER BRACKET CTB65-PM60-170 60° / Top-mounted / Back-screw**

- Allows for additional floating countertops, expanding your counter space.
- Designed to allow cables to be put through. (Max. diameter:  $\phi$  10.5)

**[Applications]**

- Commercial reception counters, kitchens, serving bars, and more.

**[Remarks]**

- Please make sure the support structure that the bracket will be attached to is strong enough to handle the load.
- Max. pitch of adjoining brackets is 900 mm.
- Max. size of countertop overhung is 1,000 mm in width and 400 mm in depth. (when using two brackets)
- Min. thickness of a countertop overhung is 20 mm.  
Min. thickness of a countertop that will support additional countertop is 30 mm.

**[Parts Included]**

- Countersunk tapping screw M5×20
- Hex head bolt M6×45
- Washer 6
- Spring washer 6

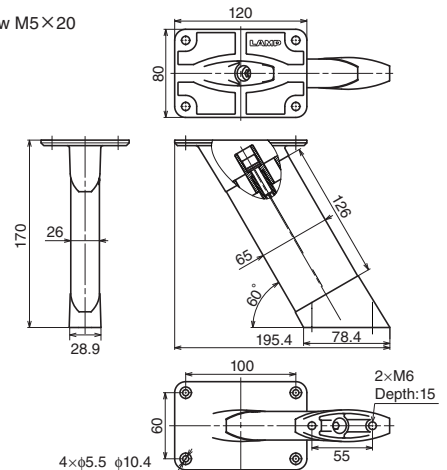
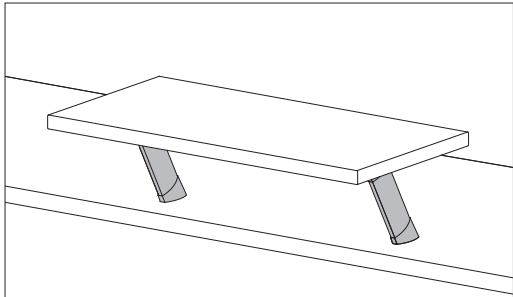
**[Installation]**

| RoHS | CAD  | Item Code   | Item Name         | Angle | Mount       | Screw | Colour Finish   | Material        | Load Capacity N / pc | Load Capacity kgf / pc | Weight (g) | Box  | Carton |
|------|------|-------------|-------------------|-------|-------------|-------|-----------------|-----------------|----------------------|------------------------|------------|------|--------|
| CE   | 2030 | 120-041-433 | CTB65-PM60-170-SL | 60°   | Top-mounted | Back  | Stainless Steel | Aluminium Alloy | 600                  | 61.2                   | 450        | 1 pc | 10 pcs |
| CE   | 2030 | 120-041-434 | CTB65-PM60-170-BL |       |             |       | Black           |                 |                      |                        |            | 1 pc | 10 pcs |
| CE   | 2030 | 120-041-435 | CTB65-PM60-170-WT |       |             |       | White           |                 |                      |                        |            | 1 pc | 10 pcs |

**RAISED COUNTER BRACKET CTB65-PMS90-270 90° / Top-mounted / Front-screw**

- Allows for additional floating countertops, expanding your countertop space.
- Designed to allow cables to be put through. (Max. diameter:  $\phi 10.5$ )

**[Applications]**

- Commercial reception counters, kitchens, serving bars, and more.

**[Remarks]**

- Please make sure the support structure that the bracket will be attached to is strong enough to handle the load.
- Max. pitch of adjoining brackets is 900 mm.
- Max. size of countertop overhang is 1,000 mm in width and 400 mm in depth. (when using two brackets)
- Min. thickness of both countertops is 20 mm.

**[Parts Included]**

- Countersunk tapping screw M5×20

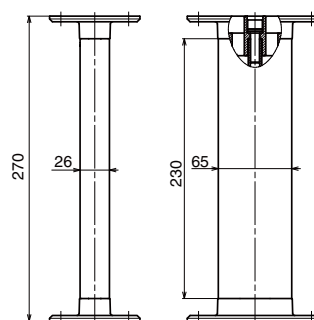
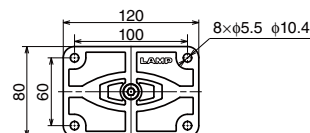
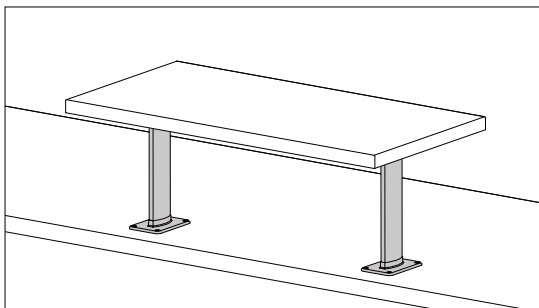
**[Installation]**

| RoHS | CAD   | Item Code   | Item Name          | Angle | Mount       | Screw | Colour Finish   | Material        | Load Capacity N /pc | Load Capacity kgf /pc | Weight (g) | Box  | Carton |
|------|-------|-------------|--------------------|-------|-------------|-------|-----------------|-----------------|---------------------|-----------------------|------------|------|--------|
| CE   | 2D/3D | 120-041-439 | CTB65-PMS90-270-SL | 90°   | Top-mounted | Front | Stainless Steel | Aluminium Alloy | 600                 | 61.2                  | 595        | 1 pc | 10 pcs |
| CE   | 2D/3D | 120-041-440 | CTB65-PMS90-270-BL |       |             |       | Black           |                 |                     |                       |            | 1 pc | 10 pcs |
| CE   | 2D/3D | 120-041-441 | CTB65-PMS90-270-WT |       |             |       | White           |                 |                     |                       |            | 1 pc | 10 pcs |

**RAISED COUNTER BRACKET CTB65-PM90-200 90° / Top-mounted / Back-screw**

- Allows for additional floating countertops, expanding your countertop space.
- Designed to allow cables to be put through. (Max. diameter:  $\phi 10.5$ )

**[Applications]**

- Commercial reception counters, kitchens, serving bars, and more.

**[Remarks]**

- Please make sure the support structure that the bracket will be attached to is strong enough to handle the load.
- Max. pitch of adjoining brackets is 900 mm.
- Max. size of countertop overhang is 1,000 mm in width and 400 mm in depth. (when using two brackets)
- Min. thickness of a countertop overhang is 20 mm.
- Min. thickness of a countertop that will support additional countertop is 30 mm.

**[Parts Included]**

- Countersunk tapping screw M5×20
- Hexagon top bolt M6
- Washer 6
- Spring washer 6

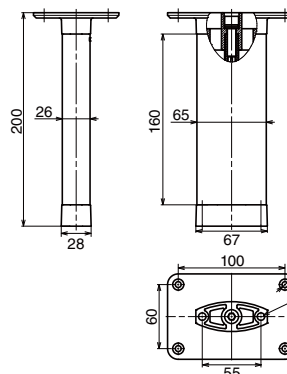
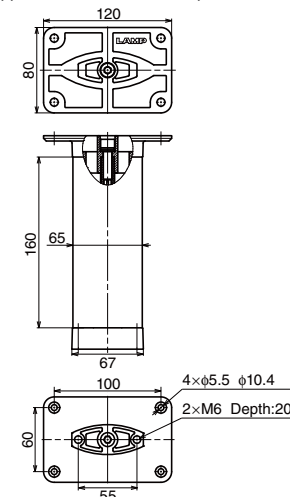
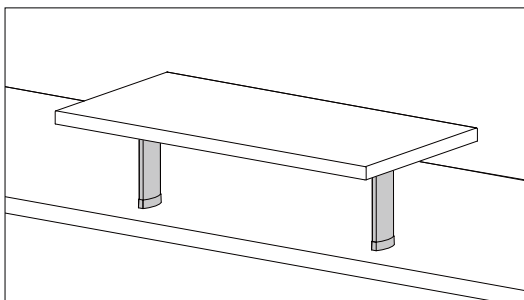
**[Installation]**

| RoHS | CAD   | Item Code   | Item Name         | Angle | Mount       | Screw | Colour Finish   | Material        | Load Capacity N /pc | Load Capacity kgf /pc | Weight (g) | Box  | Carton |
|------|-------|-------------|-------------------|-------|-------------|-------|-----------------|-----------------|---------------------|-----------------------|------------|------|--------|
| CE   | 2D/3D | 120-041-430 | CTB65-PM90-200-SL | 90°   | Top-mounted | Back  | Stainless Steel | Aluminium Alloy | 600                 | 61.2                  | 423        | 1 pc | 10 pcs |
| CE   | 2D/3D | 120-041-431 | CTB65-PM90-200-BL |       |             |       | Black           |                 |                     |                       |            | 1 pc | 10 pcs |
| CE   | 2D/3D | 120-041-432 | CTB65-PM90-200-WT |       |             |       | White           |                 |                     |                       |            | 1 pc | 10 pcs |

## RAISED COUNTER BRACKET CTB65-VM60-300 60° / Wall-mounted / Front-screw



- Allows for additional floating countertops, expanding your countertop space.
- Designed to allow cables to be put through. (Max. diameter:  $\phi 10.5$ )

### [Applications]

- Commercial reception counters, kitchens, serving bars, and more.

### [Remarks]

- Please make sure the support structure that the bracket will be attached to is strong enough to handle the load.
- Max. pitch of adjoining brackets is 900 mm.
- Max. size of countertop overhung is 1,000 mm in width and 400 mm in depth. (when using two brackets)
- Min. thickness of a countertop overhung is 20 mm.
- Min. thickness of a countertop that will support an additional countertop is 30 mm.

### [Parts Included]

- Countersunk tapping screw M5×20
- Hexagon top bolt M6×40
- Hexagon countersunk bolt M3×8
- Hexagon socket button bolt M3×8
- Washer M3
- Hexagon wrench 2

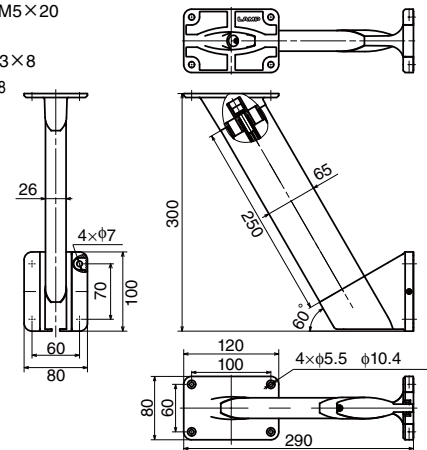

### [Installation]

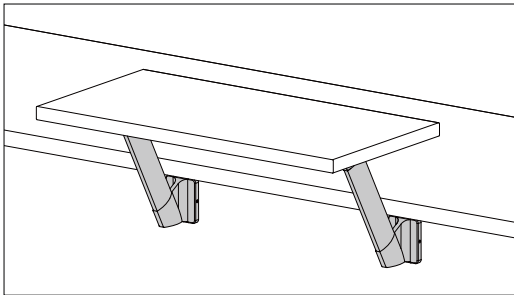

| RoHS | CAD | Item Code   | Item Name         | Angle | Mount        | Screw | Colour Finish   | Material        | Load Capacity N / pc | Load Capacity kgf / pc | Weight (g) | Box  | Carton |
|------|-----|-------------|-------------------|-------|--------------|-------|-----------------|-----------------|----------------------|------------------------|------------|------|--------|
|      |     | 120-041-436 | CTB65-VM60-300-SL | 60°   | Wall-mounted | Front | Stainless Steel | Aluminium Alloy | 600                  | 61.2                   | 930        | 1 pc | 10 pcs |
|      |     | 120-041-437 | CTB65-VM60-300-BL |       |              |       | Black           |                 |                      |                        |            | 1 pc | 10 pcs |
|      |     | 120-041-438 | CTB65-VM60-300-WT |       |              |       | White           |                 |                      |                        |            | 1 pc | 10 pcs |

## RAISED COUNTER BRACKET CTB50-PM60-170 60° / Top-mounted / Back-screw / Slim-type



- Allows for additional floating countertops, expanding your countertop space.
- Designed to allow cables to be put through. (Max. diameter:  $\phi 9.5$ )
- Slim type: the bar is thinner than other CTB65 models.

### [Applications]

- Commercial reception counters, kitchens, serving bars, and more.

### [Remarks]

- Please make sure the support structure that the bracket will be attached to is strong enough to handle the load.
- Max. pitch of adjoining brackets is 900 mm.
- Max. size of countertop overhung is 1,000 mm in width and 400 mm in depth. (when using two brackets)
- Min. thickness of a countertop overhung is 20 mm.
- Min. thickness of a countertop that will support an additional countertop is 30 mm.

### [Parts Included]

- Countersunk tapping screw M4×20
- Hex head bolt M6×40
- Washer 6
- Spring washer 6

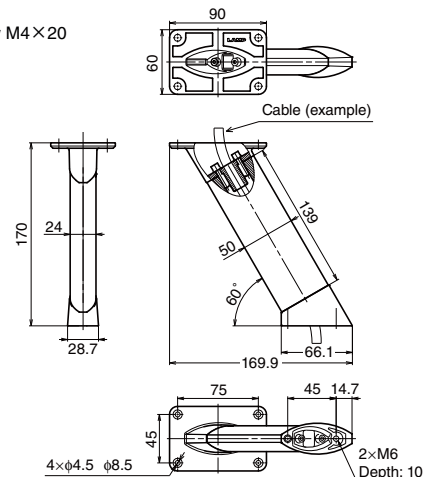

### [Installation]

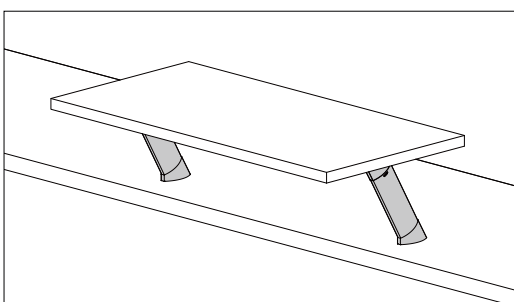

| RoHS | CAD | Item Code   | Item Name         | Angle | Mount       | Screw | Colour Finish   | Material        | Load Capacity N / pc | Load Capacity kgf / pc | Weight (g) | Box  | Carton |
|------|-----|-------------|-------------------|-------|-------------|-------|-----------------|-----------------|----------------------|------------------------|------------|------|--------|
|      |     | 120-044-785 | CTB50-PM60-170-SL | 60°   | Top-mounted | Back  | Stainless Steel | Aluminium Alloy | 400                  | 40.8                   | 366        | 1 pc | 10 pcs |
|      |     | 120-044-786 | CTB50-PM60-170-BL |       |             |       | Black           |                 |                      |                        |            | 1 pc | 10 pcs |
|      |     | 120-044-787 | CTB50-PM60-170-WT |       |             |       | White           |                 |                      |                        |            | 1 pc | 10 pcs |