

## MAGNETIC CATCH MC-YN003

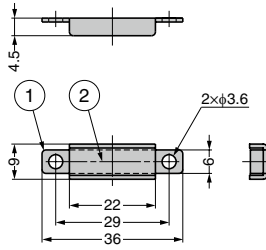

● Thin magnetic catch of 4.5mm thick ideal for tight spaces.

**[Remarks]**

- Be sure to read the "Cautions" 1.
- Please install so that the counter plate contacts the yoke on both sides. Direct contact with magnet may cause magnet breaking.

No.	Part Name	Material	Finish
①	Yoke	Steel (SPCC)	Nickel
②	Magnet	Ferrite	-

RoHS	CAD	Item Code	Item Name	Magnetic Force N	Magnetic Force kgf	Weight (g)	Box (pcs)	Carton (pcs)
RoHS	3D	140-059-540	MC-YN003	16.6	1.7	5	500	2500

Refer to 1 : P.607

## MAGNETIC CATCH MC-111, MC-112, MC-113

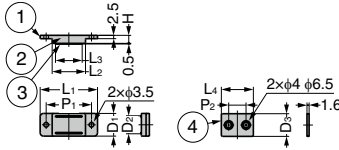

● Surface mount type thin magnetic catch ideal for tight spaces.

**[Remarks]**

- Be sure to read the "Cautions" 1.

**[Parts Included]**

- Counter plate

No.	Part Name	Material	Finish / Colour
①	Body	ABS	Black, Ivory
②	Magnet	Ferrite	-
③	Yoke	Steel	Clear Zinc Chromate
④	Counter Plate	(SPCC)	Nickel

RoHS	CAD	Item Code	Item Name	Colour	L1	L2	L3	L4	D1	D2	D3	P1	P2	H	Magnetic Force N	Magnetic Force kgf	Weight (g)	Box (pcs)	Carton (pcs)
RoHS	3D	140-059-463	MC-111B	Black	64	46	42	45	24.5	21	24	55	30	7	49	5	48	50	500
RoHS	3D	140-059-464	MC-111IV	Ivory	64	46	42	45	24.5	21	24	55	30	7	49	5	48	50	500
-	3D	140-059-465	MC-112B	Black	53	35	31	34	23.5	20	23	44	20	6.2	29.4	3	32	50	500
-	3D	140-059-466	MC-112IV	Ivory	53	35	31	34	23.5	20	23	44	20	6.2	29.4	3	32	50	500
RoHS	3D	140-059-467	MC-113B	Black	43	25	20	24	17	13.5	17	34	13	6	9.8	1	14	100	1000
RoHS	3D	140-059-468	MC-113IV	Ivory	43	25	20	24	17	13.5	17	34	13	6	9.8	1	14	100	1000

Refer to 1 : P.607

## MAGNETIC CATCH MC0750

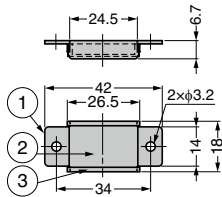

**[Remarks]**

- Be sure to read the "Cautions" 1.

No.	Part Name	Material	Finish
①	Yoke	Steel (SPCC)	Nickel
②	Magnet	Ferrite	-
③	Cover	Stainless Steel (SUS304)	Polished

RoHS	CAD	Item Code	Item Name	Magnetic Force N	Magnetic Force kgf	Weight (g)	Box (pcs)	Carton (pcs)
RoHS	3D	140-057-000	MC0750	24.5	2.5	19	150	750

Refer to 1 : P.607